

Vessel characteristics

Length overall	38.1 m (125 feet)
Beam	9.8 m (32 feet)
Range (11.5 knots)	2,400 nm
Endurance (food)	11 days
Cruising speed	11.5 knots
Azimuthing thruster power	Two L-Drives, 500 kW each
Crew berths	US: 6 International: 8
Scientist berths	US: 14 International: 12
Students	40 (on day trips)
Station keeping	Dynamic positioning
Main crane	2,400 lbs SWL
Stern A-Frame	21,000 lbs SWL
Side Frame	10,000 lbs SWL
Winches	Trawl, CTD/Hydro
Scientific instrumentation: ADCPs, multibeam echosounder, subbottom profiler, midwater imaging sonar, flow-through seawater system, broadband internet, motion reference system	

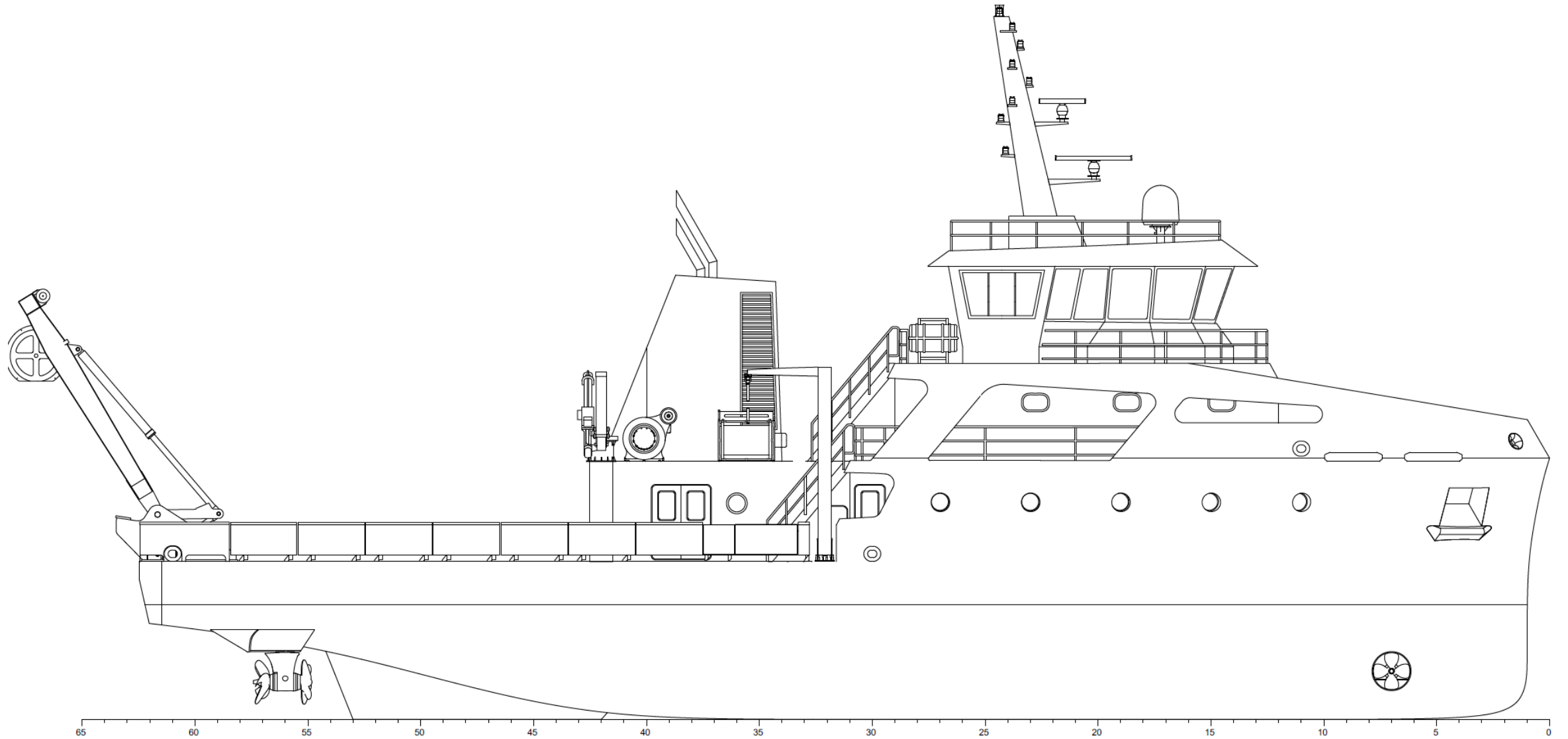

Preliminary Design



VIEW 2-4B
OUTBOARD PROFILE

Preliminary Design

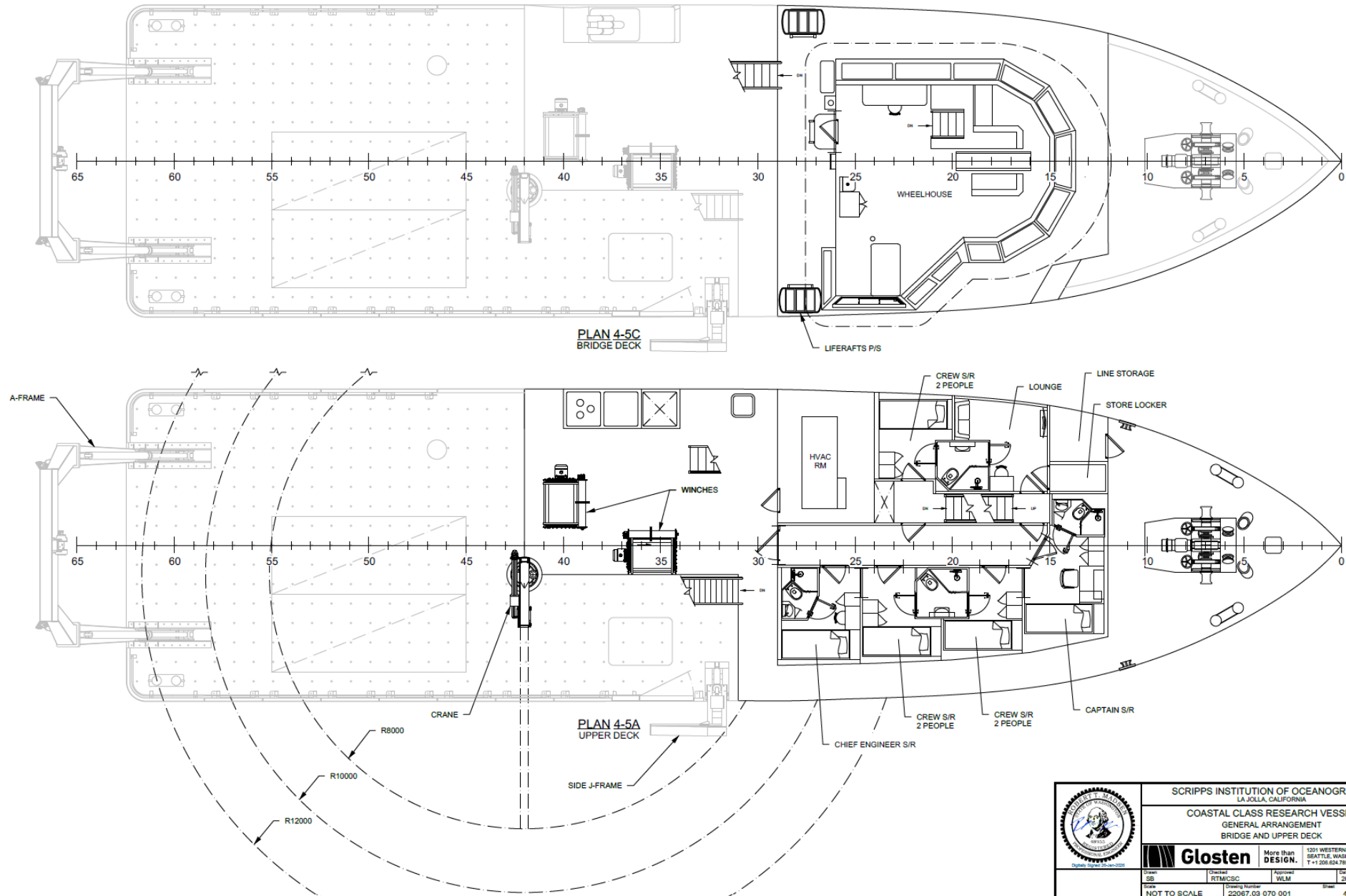

SCRIPPS INSTITUTION OF OCEANOGRAPHY
LA JOLLA, CALIFORNIA

COASTAL CLASS RESEARCH VESSEL
GENERAL ARRANGEMENT
BRIDGE AND UPPER DECK

Glosthen		More than DESIGN.		1201 WESTERN AVENUE, SUITE 200 SEATTLE, WASHINGTON 98101 T +1 206.624.7800 GLOSTHEN.COM	
Drawn SD	Checked RTM/CSSG	Approved VLM	Date 2026/01/23	Sheet 4	Total 6
NOT TO SCALE		22067.03.070.001			

Preliminary Design

SPACE	CCR/V
AFT DECK	122 m ²
SIDE DECK	31 m ²
NAVY LAB	23 m ²
BLUE LAB	23 m ²
GOLD LAB	24 m ²
C. L. DATA CENTER	12 m ²
GALLEY	13.5 m ²
MESS	20 m ²

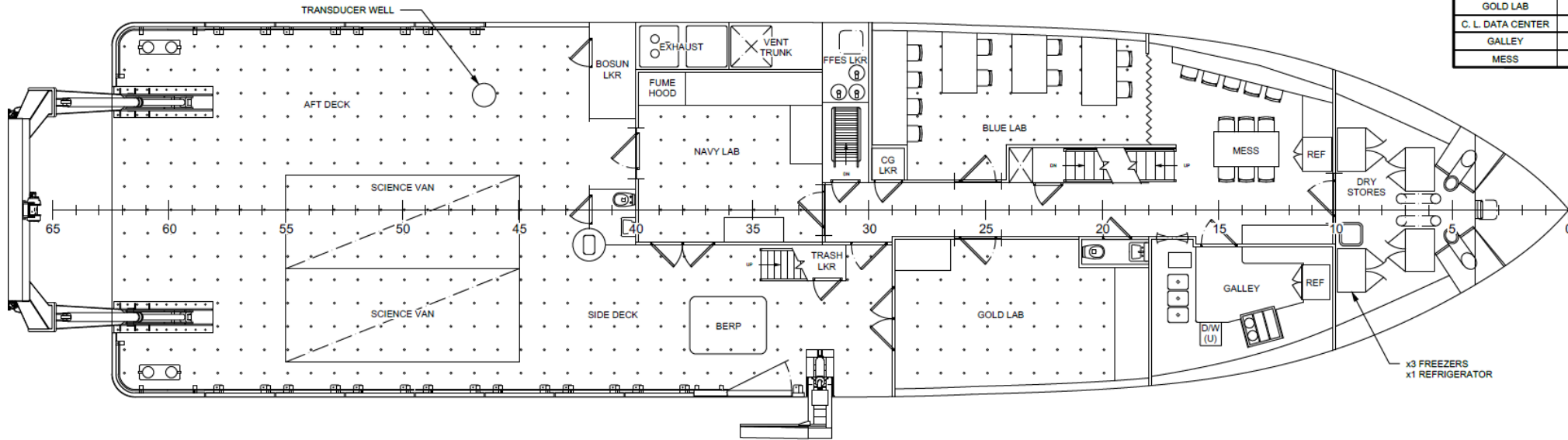

PLAN 5-5C
MAIN DECK

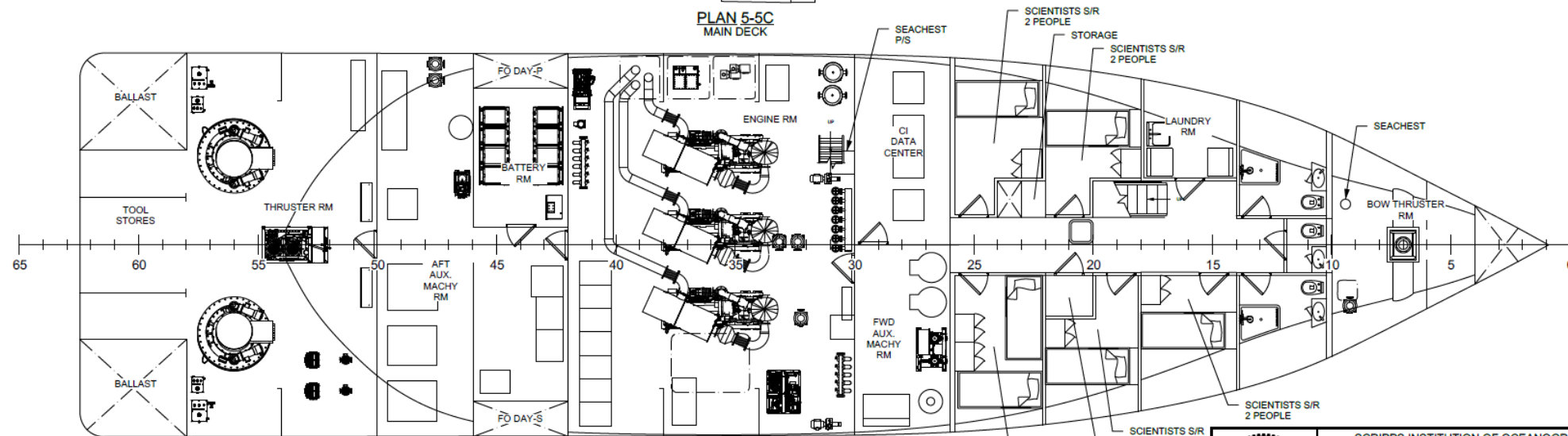

PLAN 5-5A
LOWER DECK

SCRIPPS INSTITUTION OF OCEANOGRAPHY
LA JOLLA, CALIFORNIA

COASTAL CLASS RESEARCH VESSEL
GENERAL ARRANGEMENT
MAIN AND LOWER DECK

Glosten More than DESIGN.

1201 WESTERN AVENUE, SUITE 200
SEATTLE, WASHINGTON 98101
T+1 206.624.7850 GLOSTEN.COM

Drawn SB	Checked RTM/CSC	Approved WLM	Date 20/26/01/23		
Title NOT TO SCALE		Drawing Number 22067.03 070 001		Sheet 6	Revision 6